



2 Boolarong Road Pymble, ACT

 5  2  2

Tranquility, comfort and style

This superb double brick home, originally called 'Nerigunda,' offers a contemporary lifestyle of tranquility, comfort and style in one of Pymble's most prestigious streets. A traditional architectural residence updated and extended over the years to meet the needs of the established family, this is an inviting home defined by quality and substance. Enviably located, this property is in the catchment for highly sought-after Pymble Public School and within walking distance of Pymble Station. Buses nearby head to Pymble, Turramurra, Gordon and Macquarie Park, while St Ives Shopping Village is just minutes away. This family-friendly address enables easy access to the CBD as well as the north shore's most esteemed private schools.

Price: \$2,250,000 - For Sale

Phil Orr
0412991133



Upper Floor

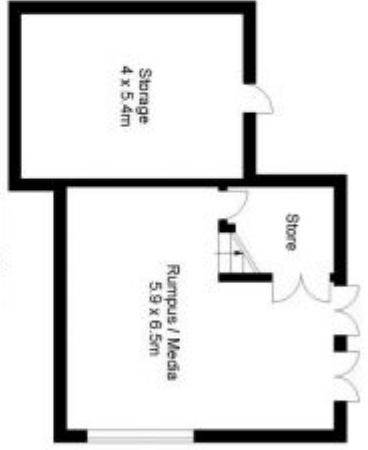
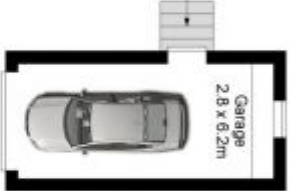

Lower Floor



Site Plan (Not To Scale)

Internal : 242m²
 Land Size : 928m²

Scale in meters, indicated only. Dimensions are approximate. All information contained herein is gathered from sources we believe to be reliable. However we cannot guarantee its accuracy and interested persons should rely on their own enquiries. www.sdgproject.com.au

2 BOOLARONG ROAD, PYMBLE