



11 Yarrowonga Close Pymble, NSW

 4  2  2

## Light filled family home in private cul-de-sac setting

Offering an immediate sense of light and space, this superbly presented residence showcases an impressive flowing floorplan with a selection of living and entertaining spaces. Its' beautifully manicured gardens are visible from floor-to-ceiling windows in every room. Presenting an outstanding opportunity for downsizers and young families alike, it features a single storey layout with very few steps throughout. It is enviably placed in a peaceful family-friendly cul-de-sac setting within the catchment for Killara High School, and just 700 metres from Gordon East Public School. Gordon Station is within comfortable walking distance, and buses are easily accessible.

**Price:** - For Sale

**Phil Orr**  
0412 99 11 33

**Tam Orr**  
0415 17 85 05

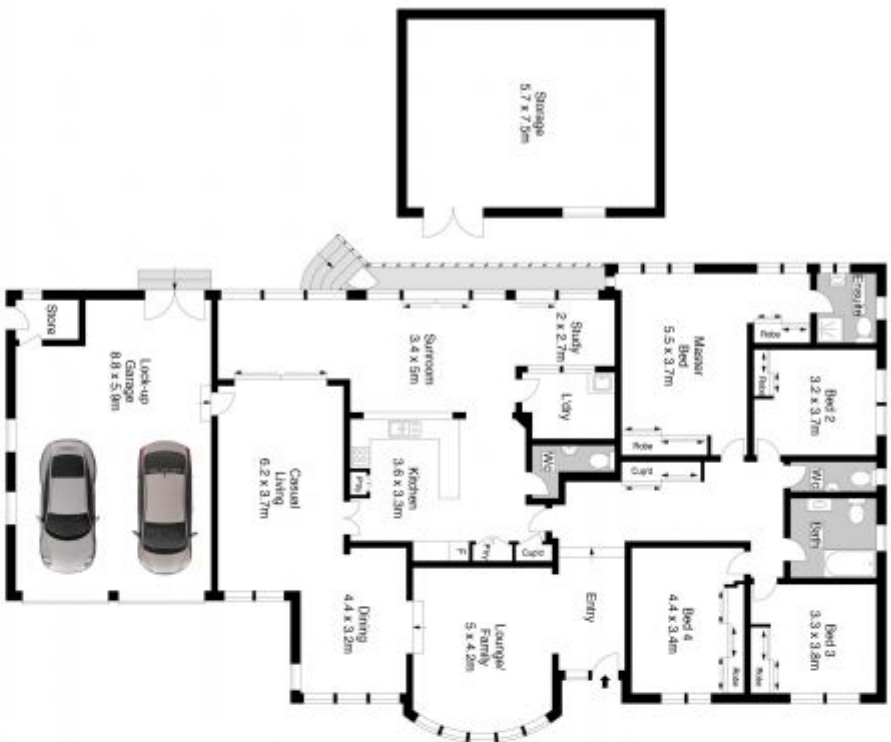

Site Plan (Not To Scale)



# 11 YARRAWONGA CLOSE, PYMBLE

Internal : 291m<sup>2</sup>  
 Land Size : 1074m<sup>2</sup>



Scale in metres. Indicated only. Dimensions are approximate. All information contained herein is gathered from sources we believe to be reliable. However we cannot guarantee its accuracy and interested persons should rely on their own enquiries. [www.kidston.com.au](http://www.kidston.com.au)